

Make LED lighting choices with your customer's buying motives in mind!™



ACCENT 2 LED BORDER TUBE

Installation Instructions

Perfection is in the details!



LIST OF MATERIALS:

1. **Accent 2 tubes (ACA2-96-z)** - standard 96" lengths, pre-assembled and factory sealed. (includes 7 mounting clips)
2. **Accent 2 tubes** - custom lengths (3" increments), pre-assembled and factory sealed. (see chart for actual lengths)
3. **Accent 2 clips (ACA2-MC)** - used to mount accent 2 tube to the wall and hide wires. One clip per 16" plus one larger alignment clip (ACA2-MCL) are provided. (photo 1)
4. **80-watt 24-volt transformer (PSA-24-80)** - powers 35 to 40 feet depending on color. (see loading chart)

INSTALLATION INSTRUCTIONS:

1. Measure the wall to determine the number of 96" standard length Accent 2 tubes and the lengths of the custom tubes. Allow for room between tubes for heat expansion. (photo 2)(see thermal expansion chart)
2. Add 1.5" to the length of one side for an outside corner (photo 3). Subtract 1.5" from the length of one side for an inside corner (photo 4).
3. Measure and then mark the wall or use a snap line to guide the installation of the Accent 2 tubes.
4. Secure the mounting clips to the wall, evenly spaced on 16" centers maximum. (photo 5) Mount longer clips where two lengths will join. (photo 2)



5. Mount one Accent 2 tube to the wall. Then, connect both wires from the next tube to the corresponding wires from the installed tube using silicone-filled 3M connectors provided, matching wire colors. (photo 6)

USING THE 3M CONNECTOR:

6. Without stripping the insulation, insert both wires fully into any two holes and crush with pliers as shown. Pull both wires to check whether proper connection has been made. Tuck the wires behind the tubes under the clips to hold them in place. (photo 8) Accent 2 is polarity sensitive so connect positive to positive (yellow) and negative to negative (black).
7. Connect these two Accent 2 tubes to the power source secondary wires. Note: power source positive wire is red and negative wire is blue.
8. Repeat this process with the remaining Accent 2 tubes finishing with the custom length on each wall. The required custom length(s) can be assembled by US LED and factory sealed (or your installer can custom cut and assemble if preferred, using an Accent 2 tube assembly kit).
9. Plan for the placement of the power sources (transformers). These power sources can be placed in a standard neon transformer can. No more than two transformers should be put in an outdoor transformer can.
10. Be sure to make all electrical runs & connections in compliance with all applicable national & local codes.



Designed with
the sign company
and the end user
in mind.™

USLED
1800 Bering Dr.
Houston, TX 77057

TOLL-FREE
866.972.9191
713.972.9191
713.972.9393 FAX

www.usled.com



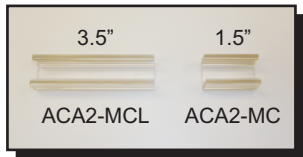

Photo 1
Mounting clips



Photo 2
Two tubes w/connector clip

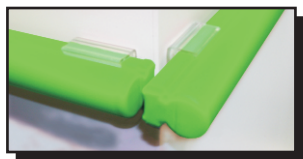

Photo 3
Outside corner overlap

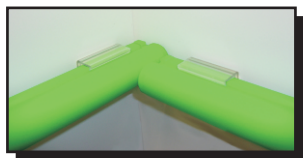

Photo 4
Inside corner overlap

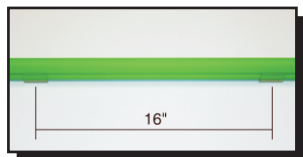

Photo 5
Std clips on 16" centers

BUILDING PLAN VIEW
ACCENT TUBES ON W, S, & E ELEVATIONS

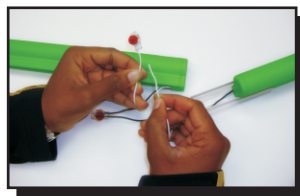
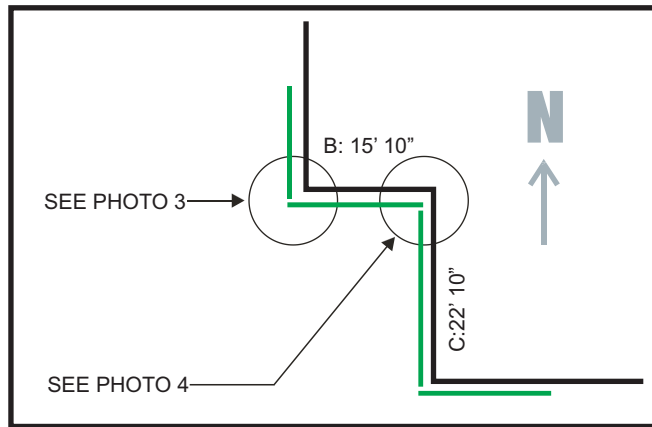

Photo 6
Installing 3M connector



Photo 7
Crushing 3M connector



Photo 8
Wires tucked behind clip

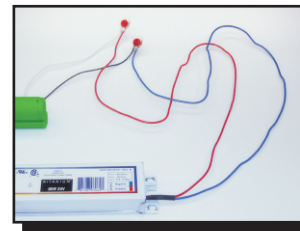

Photo 9
Connected to power source

ACTUAL TUBE LENGTHS
96"
93"
90"
87"
84"
81"
78"
75"
72"
69"
66"
63"
60"
57"
54"
51"
48"
45"
42.125"
39.125"
36.125"
33.25"
30.25"
27.25"
24.25"
21.25"
18.375"
15.375"
12.375"
9.375"
6.5"
3.5"

THERMAL EXPANSION CHART: (TEMPERATURE AT THE TIME OF INSTALLATION)	TEMPERATURE	100° F 38° C	80° F 27° C	60° F 16° C	40° F 4° C
	GAP BETWEEN ACCENT TUBES	.125" 3.18mm	.250" 6.35mm	.375" 9.53mm	.500" 12.70mm